



MELBOURNE MODERN

■ WINDOWS BY DESIGN USE ELEVATE SYSTEMS TO CONTRIBUTE TO THE INDUSTRIAL FEEL OF THIS LIGHT FILLED HOME

The inspiration for this home came from a project the owners Kara and Lloyd saw featured on Grand Designs UK, named the Sugar Cube. They were fascinated by the amount of glass which gave incredible natural light; the two-storey void area; and the general aesthetics of the home.

The brief given to Canny Architecture was to have a stylish, open plan home that was child-friendly without compromising on the design. Canny Architecture drew on inspiration from the Sugar Cube home while also

keeping the brief in mind. A playful dialogue between the two homes emerged.

Black aluminium makes a robust statement which helps to give the home an industrial warehouse look and feel. Part of the brief was to incorporate industrial finishes throughout the home and exterior.

The black powder coat finish on the windows and doors was selected to allow the owners to change the theme colours in the interior as their style changes over time.

AWS | PROJECT FEATURE

The desire for large windows meant that the orientation of the house had to be carefully considered with regards to heating and cooling the home. The home achieves a six star energy rating, enabled through careful material selections including double glazing throughout.

Picture frame-like windows are strategically placed around the home. The main living room has natural light at all times of the day.

Two three-panelled Series 704 Slide MASTER™ sliding doors were incorporated to link the interior to the exterior with Series 426 FrontGLAZE™ framing. They give a sense of connecting the two areas when open while also giving a clear view into the garden, essential when young children are playing outside.

Kara and Lloyd wanted a home that reflected their personalities and the way they liked to live. Canny Architecture, with the help of window fabricator Windows by Design, achieved just that.



For more information and the full gallery, visit:
elevatealuminium.com.au

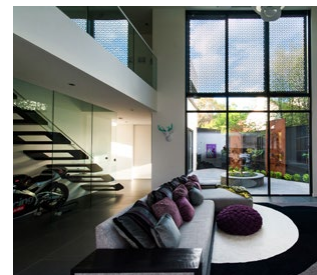

Architect: Canny Architecture | Photographer: Rebekah Jewell

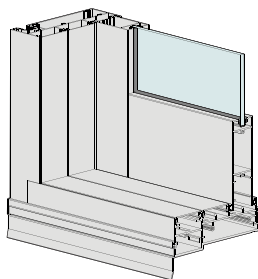

ELEVATE™ SERIES 704 SLIDEMASTER™ SLIDING DOOR

- × The Series 704 high performance sliding door has been tested for compliance with the relevant Australian Standards. This sliding door has a high water resistance of 450Pa and complies with the air conditioning requirements of the standard.
- × Series 704 sliding doors run on heavy duty double bogey wheel carriages.
- × The extra strong multi-hollow meeting stiles allow large sliding doors to be fabricated in high wind load areas.
- × The Series 704 sliding door is compatible with the high performance Series 406 / 606 and 426 / 626 FrontGLAZE™ framing.
- × These sliding doors can be fitted with surface mounted deadlock, mortice lock or multi-point mortice lock.
- × Sliding doors can be fitted with internal sliding or roller flydoors.
- × The Series 704 sliding doors can be fitted with Centor SIE Eco Screen



Windows By Design are leading manufacturers of contemporary architectural aluminium window and door systems. The team will provide you with technical advice, design expertise and quality workmanship to ensure the highest quality products for your project. Let the team at Windows By Design work with you to select the ideal product for your project to maximise the functionality and aesthetics, as well as energy and performance outcomes of your windows and doors.

2D & 3D CAD Files Available | Download from specifyaws.com.au to use in your projects.

For more information on this and the rest of the Elevate™ Aluminium Systems range: elevatealuminium.com.au

